

Climate
Control

IMI Heimeier

Halo-B



Thermostatic heads

Secured model designed for public buildings

Halo-B

The thermostatic head Halo-B is used for individual room temperature control in public buildings, e.g. government agencies, schools etc. which are used by a large number of members of the public. The Halo-B combines high precision control with slim, cylindrical design.



Key features

Protected against theft

Flexural strength of the thermostatic head min. 1000 N

Infinitely variable temperature setting using a special key without removing the protection cap

Combining the minimalistic design with extra robustness even in the toughest environments e.g. in public buildings

Protection cap can be turned endlessly

Liquid-filled thermostat with high pressure power and precision control

Technical description

Applications area:

Heating systems

Functions:

Room temperature control.
Frost protection.

Control behavior:

Proportional controller without auxiliary energy. Liquid-filled thermostat. High pressure power, lowest hysteresis, optimal closing time.
Stable control behavior even in the case of small calculated p-band variation (<1K).

Nominal temperature range:

8 °C to 26 °C (46 °F to 79 °F).

Temperature:

Max. sensor temperature: 50°C (122°F)

Specific extension:

0.22 mm/K,
Valve stroke limiter

Control accuracy, CA value:

0.6 K

Water temperature influence:

0.8 K

Differential pressure influence:

0.3 K

Closing time:

26 min

Hysteresis:

0.4 K

Material:

PBTGF15, PA6.6 GF30, PPA GF60,
PPO/PAGF20, brass, steel.
Liquid-filled thermostat.

Colour:

White RAL 9016

Marking:

IMI Heimeier and KEYMARK symbol.

Standard:

KEYMARK certified and tested according to EN 215. See also leaflet "Thermostatic Heads - General".



Connection:

Designed to be mounted on all IMI Heimeier thermostatic valve bodies and radiators with integrated valves which have an M30x1.5 thermostatic insert. In some cases a spindle extension is needed - see "Accessories".
Protected against theft.
Flexural strength of the thermostatic head min. 1000 N. (Halo-B tested according to EN 215. Kits and accessories were not in the scope of the test.)

Function

In terms of controls, thermostatic heads are seen as continuous proportional controllers (P controllers) that require no auxiliary energy. They do not need an electrical connection or other source of energy. Changes in room air temperature are proportional to changes in the valve stroke.

If the temperature of the air in the room increases due to sunshine, for example, the liquid in the temperature sensor expands and affects the corrugated pipe. This chokes the water supply to the radiator via the valve spindle. If the temperature in the room decreases, the opposite process occurs. The change in valve stroke caused by a change in temperature can be quantified as 0.22 mm per K room temperature change.

Application

IMI Heimeier thermostatic heads are used to control the temperature of individual rooms using, for example, heaters, convectors, and radiators.

They are designed to be mounted on all IMI Heimeier thermostatic valve bodies and on radiators with integrated valves which have an M30x1.5 connecting thread on the thermostatic insert. Adapters and models with direct connections enable mounting onto thermostatic valve bodies from other manufacturers.

The thermostatic heads use the energy of internal and external heat sources including solar heat, the heat radiated from people and electrical devices, and other sources, in order to keep the room air temperature constant. This helps to avoid wasting energy.

Thermostatic heads with built-in sensors may not be covered by curtains, radiator facings, or other obstructions, or mounted vertically or in tight niches. Otherwise it will not be possible to precisely control the temperature.

In other cases, it may be necessary to install a remote sensor or remote dial (see leaflet "Thermostatic head F").

Notes on installation



Correct
Circulation of air around the thermostatic head is not hindered.



Correct
The remote sensor enables an unhindered reading of the air temperature in the room.



Underfloor convector
(Thermostatic head F)



Incorrect
The thermostatic head with built-in sensor may not be mounted vertically.



Incorrect
The thermostatic head with built-in sensor may not be covered by curtains.



Built-in cabinet
(Thermostatic head F)

Operation

The various settings give approximately the following **room temperatures:**

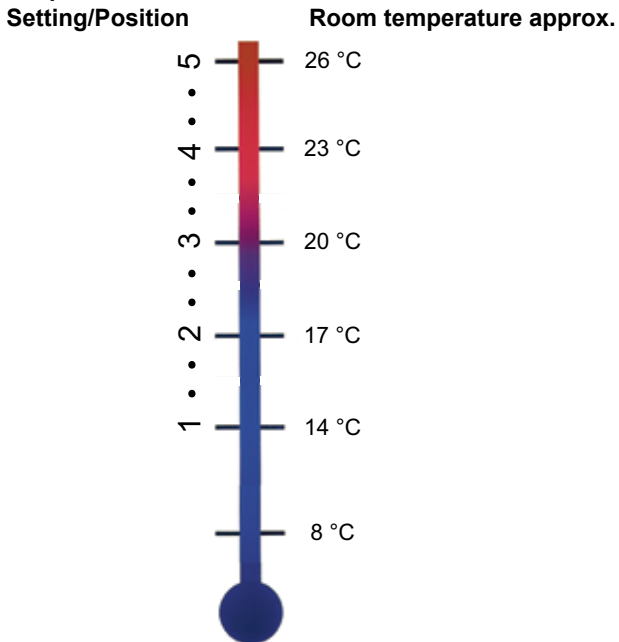

Setting the temperature

Use a small screwdriver to lever out the end plug (1). Set the required value in the temperature range between 8 °C and 26 °C with the universal key (Item No. 0530-01.433) through the end opening (2). Introduce the universal key in the central opening and turn the key until the latter will catch or lock. Then adjust the reference value by turning. The corresponding numbers are shown in the viewing window. Number 3 corresponds to a room temperature of about 20 °C. The difference between the numbers is about 3 °C. Press the end plug back in until it snaps into position.

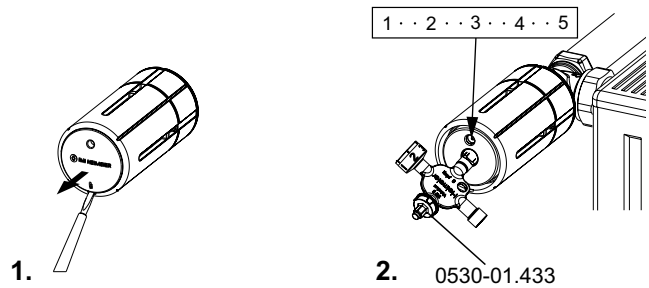

Articles

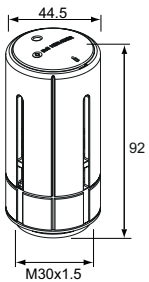

Halo-B

For public buildings

Setting range	EAN	Article No
8°C - 26°C	4024052188512	2500-00.500

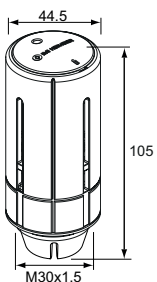

Halo-B Danfoss-RA Kit

For direct fitting to Danfoss RA valves. **Note:** Adapter not mounted at delivery. For public buildings

Setting range	EAN	Article No
8°C - 26°C	4024052004935	2500-01.500

Accessories

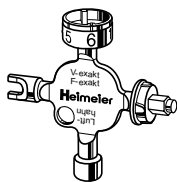

Universal key

For activating thermostatic head Halo-B and B (temperature setting). Also for V-exakt **to end of 2011** / F-exakt thermostatic valve bodies, Regulux lockshield, Vekolux double connection fittings, and radiator air vents.

EAN

Article No

4024052338917

0530-01.433



Spindle extension

To be used when needed for some older radiator valves and some radiators with integrated valves with M30x1,5 connection. Needed in combination with angle connection art. No. 7300-00.700.

L

EAN

Article No

10

4024052011650

2201-10.700

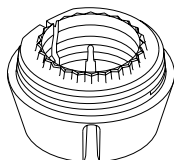

Danfoss RA adapter

For direct fitting to Danfoss RA valves. For thermostatic heads with M30x1,5 connection.

L

EAN

Article No

13

4024052089161

9702-25.700



The products, texts, photographs, graphics and diagrams in this document may be subject to alteration by IMI without prior notice or reasons being given. For the most up to date information about our products and specifications, please visit climatecontrol.imiplc.com.